

*Expansion Joint Material:
 AASHTO M153
 Type-I Sponge Rubber
 Type-II Cork permitted with contractor provided documentation that the Build America Buy America requirements are satisfied.

** Preformed Neoprene Rubber Sheet:
 50 Durometer
 AASHTO M251, Grade 3

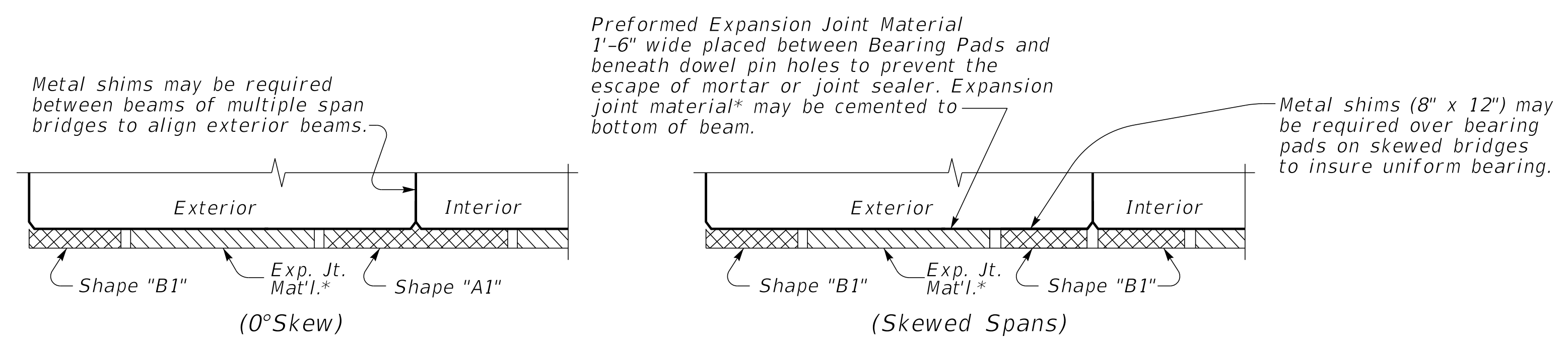

SHOWING PADS FOR BEAM TYPES B27-B42 & CB27-CB42

Use 1/2" x 1'-6" preformed neoprene rubber sheet** for beam types B12-B21 & CB12-CB21 for bearing.

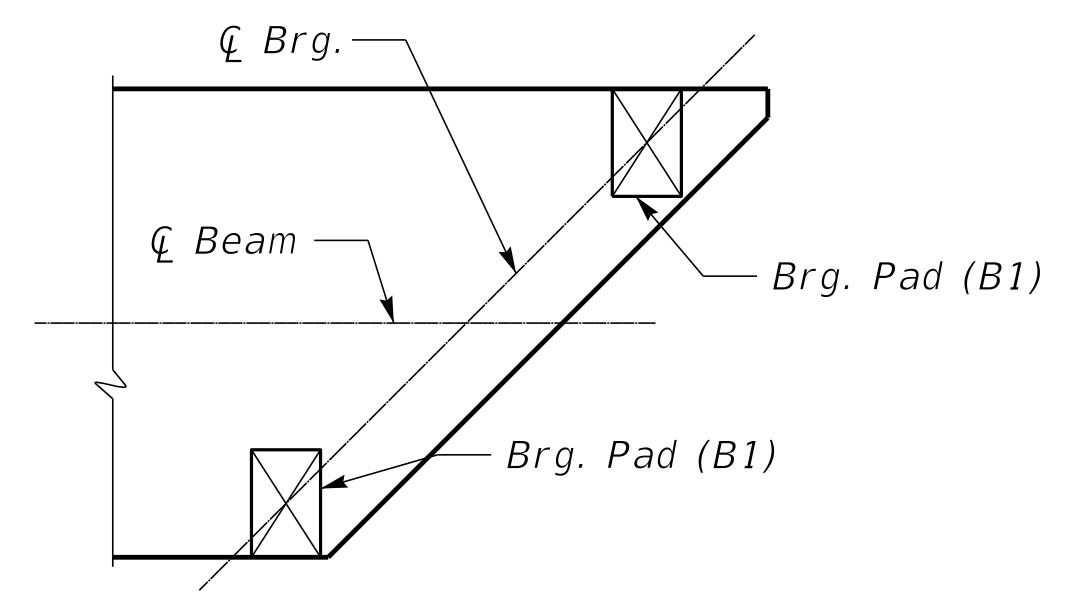

PAD PLACEMENT FOR SKEWS

Pads "B1" are to always be placed perpendicular to beam with center of pad over bearing.

GENERAL NOTES

Provide metal shims conforming to ASTM A36 and galvanize in accordance with ASTM A123. As alternates, polymer, or elastomer shims may be used. Include the cost of furnishing and placing these shims in the price per beam.

SUBMITTED *Michael Crisp* 10/25/2024
 DIVISION DIRECTOR DATE